

REV.	DATE	DESCRIPTION	ECN#	BY

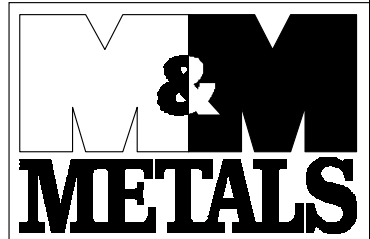
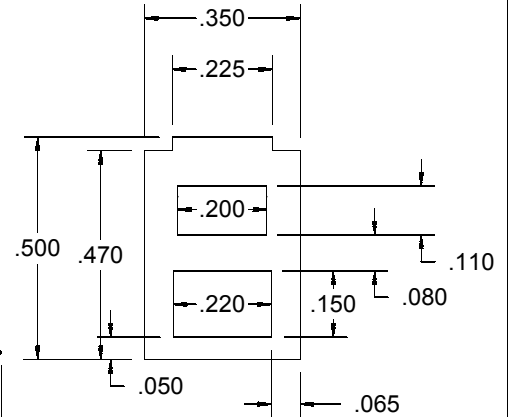
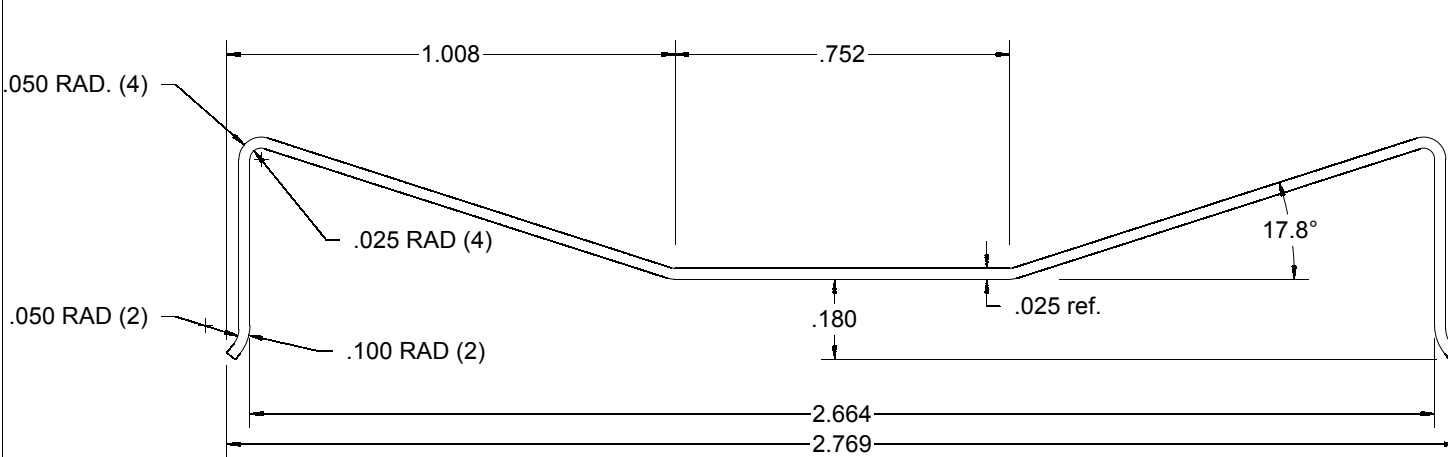
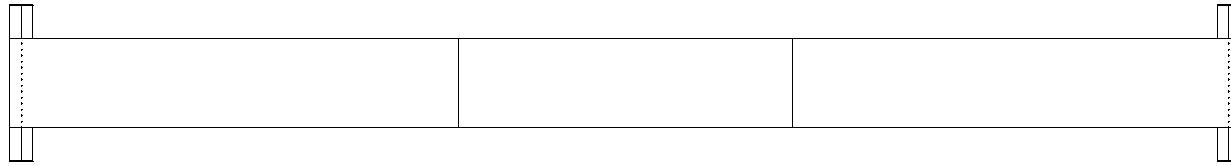

908 E. PIONEER DR.  
 IRVING, TX 75061  
 PHONE: 972-721-7174  
 FAX: 972-438-1247  
 e-mail: heatsink@mmmetals.com  
 www.mmmetals.com

<b>4</b>	
<b>3</b>	
<b>2</b>	PART TO BE CLEAN AND FREE OF DIRT, GREASE, OR CONTAMINATES
<b>1</b>	REMOVE ALL BURRS AND SHARP EDGES
<b>NOTES (UNLESS OTHERWISE SPECIFIED)</b>	

**NOTICE OF PROPRIETARY INFORMATION**

THIS DOCUMENT IS THE PROPERTY OF M&M METALS AND SHALL NOT BE REPRODUCED OR COPIED, IN WHOLE OR IN PART, WITHOUT THE WRITTEN PERMISSION OF M&M METALS.

TOLERANCE (UNLESS OTHERWISE SPECIFIED)	DWG. BY: B.H.	DATE: 6/6/02
DIMENSIONS IN INCHES	CHECKED BY:	DATE:
X.XX = ±.020 X.XXX = ±.010 ANGLE = ± 3°	APPROVED BY:	DATE:
FINISH: CLEAR ZINC	ECN#: 0260	DATE: 6/6/02
MATERIAL: .025 301 SPRING STEEL FULL HARD		

TITLE BLOCK	<b>DO NOT SCALE DRAWING</b>
<b>CLIP CLP-0001</b>	
SIZE: A	DRAWING NUMBER: <b>MM5105</b>
REV.:	SHEET 1 OF 1