

M&M Metals

Heat Sinks for DC to DC Converters

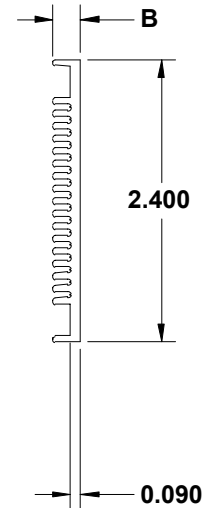

- Extruded aluminum fin heat sink for forced or natural convection applications
- Standard mounting hole pattern
- Horizontal or vertical fin configuration to match your applications air flow direction
- Range of fin heights available
- Optional factory applied thermal pad and/or mounting hardware in a ready to use kit form
- Black anodize standard

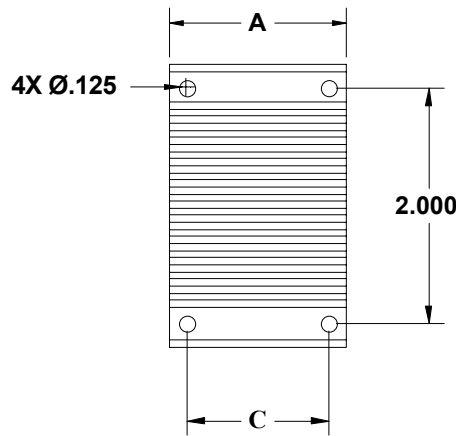
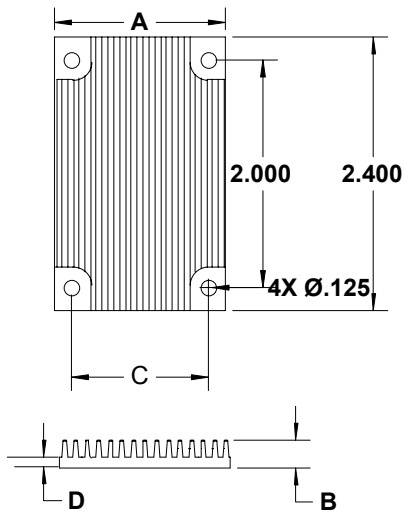

Vertical (V) fin arrangement

Horizontal (H) fin arrangement

Part Number	Fin arrangement / number of fins	Dimension A (inches)	Dimension B (inches)	Dimension C (inches)	Dimension D (inches)
MM5006B	H / 19	1.500	0.240	1.200	---
MM5011B	H / 19	1.500	0.440	1.200	---
MM5018B	H / 19	2.260	0.240	1.900	---
MM5019B	H / 19	2.260	0.440	1.900	---
MM5015B	V / 15	1.500	0.240	1.200	0.090
MM5013B	V / 15	1.500	0.440	1.200	0.090
MM5016B	V / 23	2.260	0.240	1.900	0.090
MM5020B	V / 8	2.260	0.400	1.900	0.060
MM5017B	V / 10	2.260	0.470	1.900	0.130

908 E. Pioneer Drive
 Irving, TX 75061
 Phone: 972-721-7174
 Fax: 972-438-1247
 E-mail: heatsink@mmmetals.com

Kit Options – Contact Factory

- U: Unfinished heat sink
- S1: 3mm x 8mm Sims Screws – 4 count
- G1: 1.25 x 1.75 pre-applied Grafoil pad
- G2: 2.0 x 1.75 pre-applied Grafoil pad